

MOUNTING INSTRUCTIONS

LHF

VER.07-2017EN

Company Kružík s.r.o. has developed the complete set of track system for sectional doors of residential buildings. It was specially developed for the situations with a headroom of min. 250mm.

The set has got following characteristics:

- Springs in the front, behind the headroom
- Inner wire guide
- Size for installation: 100mm side room, 250mm headroom

In this handbook we are mentioning the instructions for the correct installation of our track system. This handbook is dedicated to be used by experienced and qualified technicians and it's not advisable for handymen or for using by unschooled personal.

In this handbook we are mentioning the instructions for the correct installation of our track system. The supplier answers for the installation of the whole door. This handbook is dedicated to be used by experienced and qualified technicians and it's not advisable for handymen or for using by unschooled personal.

The standard track system set is composed by following parts:

- A set of rails (vertical and horizontal)
- B necessary standard parts/ basic material for montage
- C fittings (hinges, wheels, etc.) from selected material
- D set of wires
- E torsion bar
- F torsion spring

Notice: Parts (bolts, etc.) required for mounting the tracks to the wall or for its hanging to the side wall or ceiling are not included.

Optional equipment

- G connecting/hanging profiles of horizontal rail set
- H upper sealing for montage to lintel

We are sure that you will successfully install the track system.

When you will have some questions or you will need to clear up any problem please don't hesitate to contact Kružík Ltd.

ATTENTION!

- ! **This handbook describes just the installation of the track system parts and it's necessary to complete it with instructions for the montage of any optional parts.**
- ! **Carefully read this handbook before beginning the installation.**
- ! **Some of the parts might be sharp or might have burrs.**
We recommend using protective gloves.
- ! **All supplied parts are engineered for using with up-and-over doors.**
- ! **Through the tension the springs can put out heavy forces. Work carefully. Use proper equipment. Respect that you stay in a stationary position.**
- ! **By the installation ensure enough light. Remove obstructions and dirtiness. Ensure that there is no one to assist except the mounters on the installation place. Other persons (children) can be in the way through the installation and they could threaten themselves.**

Equipment necessary for correct and fast installation

Electro-tools

Drilling machine
Impact drilling machine
Aku-drilling machine
grinder

tools

o-keys 10, 13, 14, 15, 17mm
gola set 10, 13, 17
set of imbus keys
nut 10, 13mm + prolonged bits
adapter
combination pliers, gas pliers
hammer

air level
yardstick
pencil
2× bar for springs tensing
rope
2 blocks, appr. 20 and 40mm high
clips

The construction conditions on the site are for sectional private and industrial doors installation and their further flawless operation essential!

- surface flatness
- for the sectional door installation they have to be even (side room, headroom, floor). Side room and headroom have to run in one line. Maximal allowed flatness variations are +/-2mm.
- masonry base for installation has to be solid and dry. In the mounting area is no electric wiring within the walls allowed.
- each larger unevenness of the mounting base, can have a negative influence on the proper door operation. Use plugs with 12mm diameter to fix the sectional doors in the masonry wall.

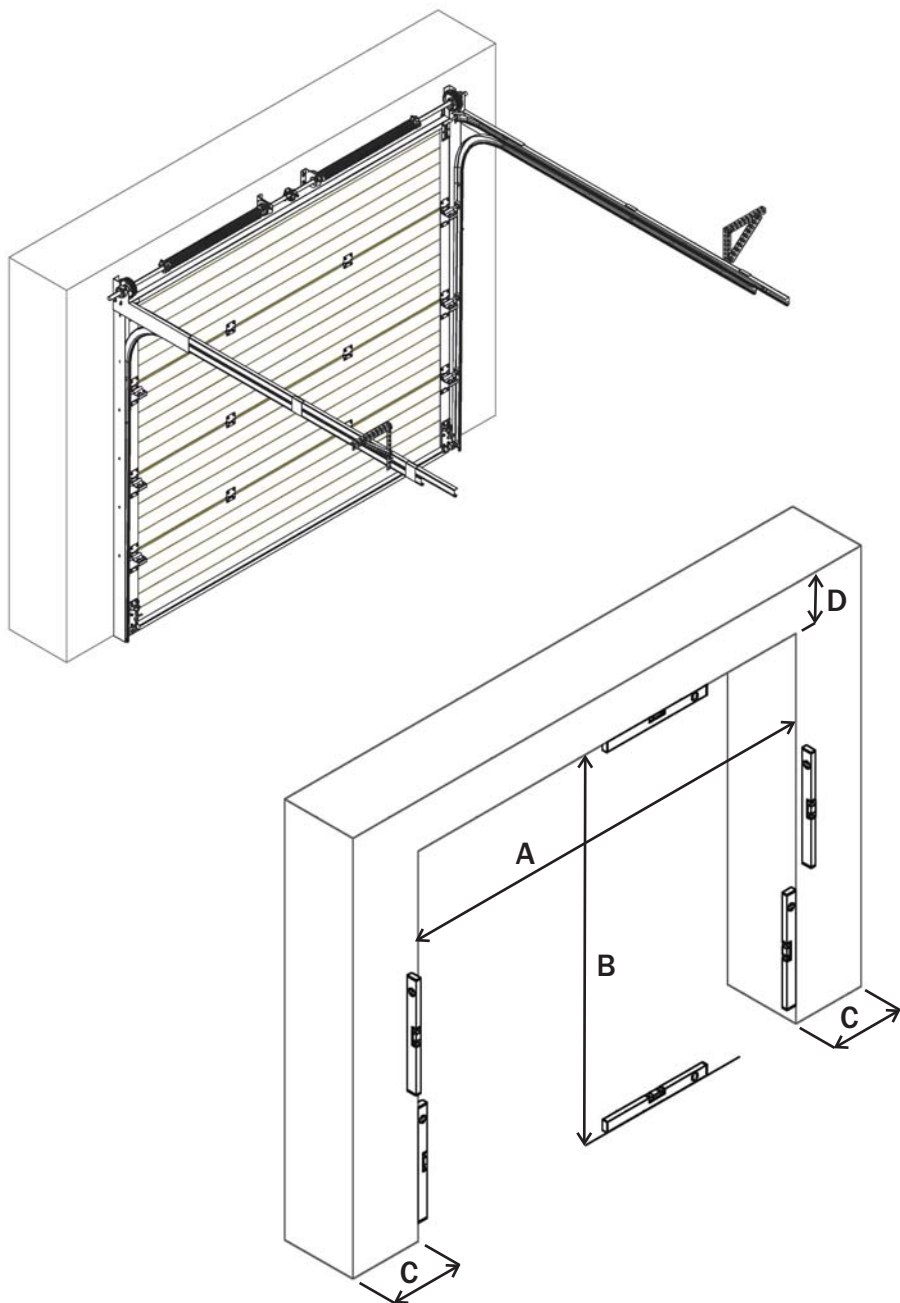

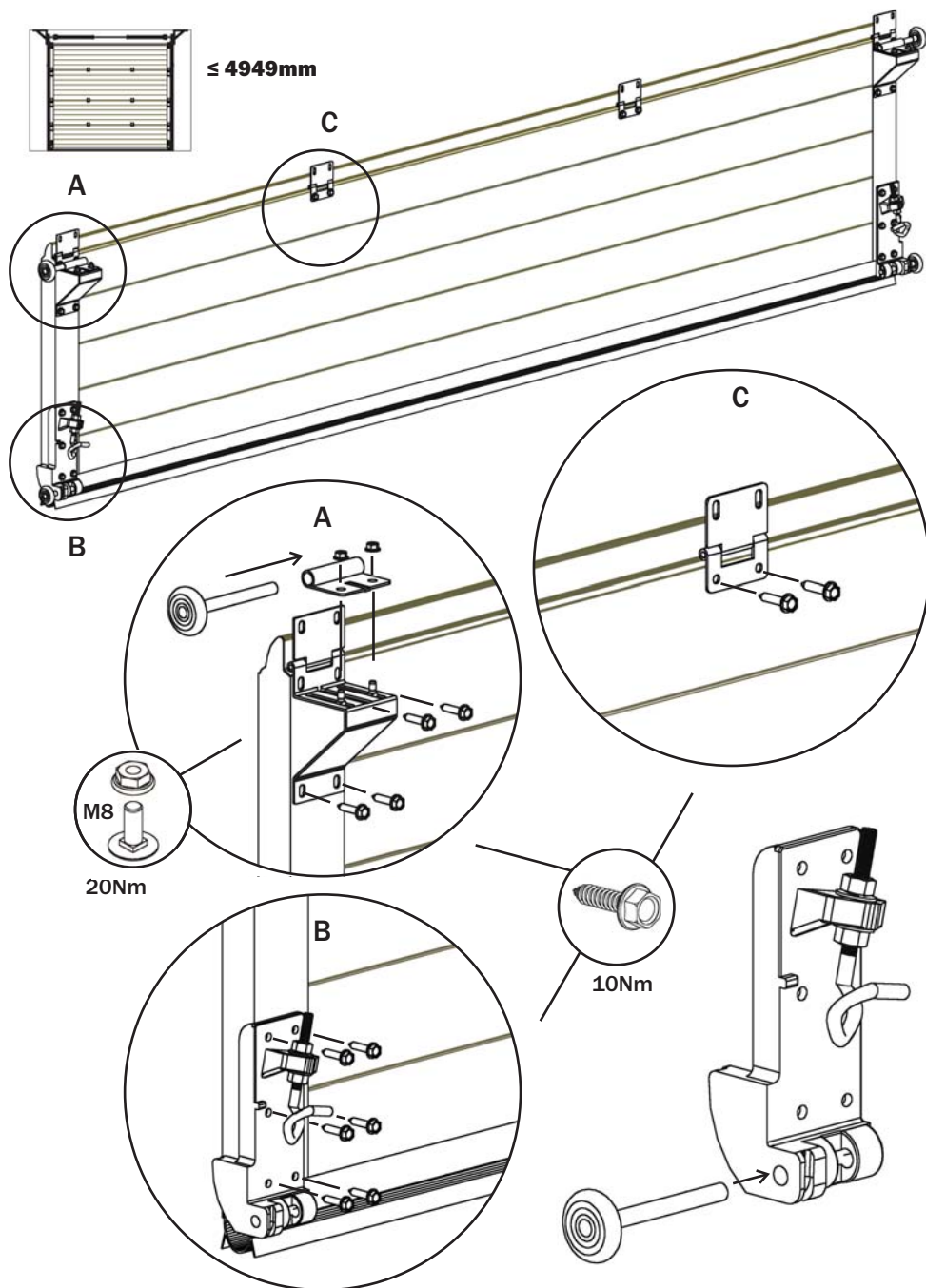

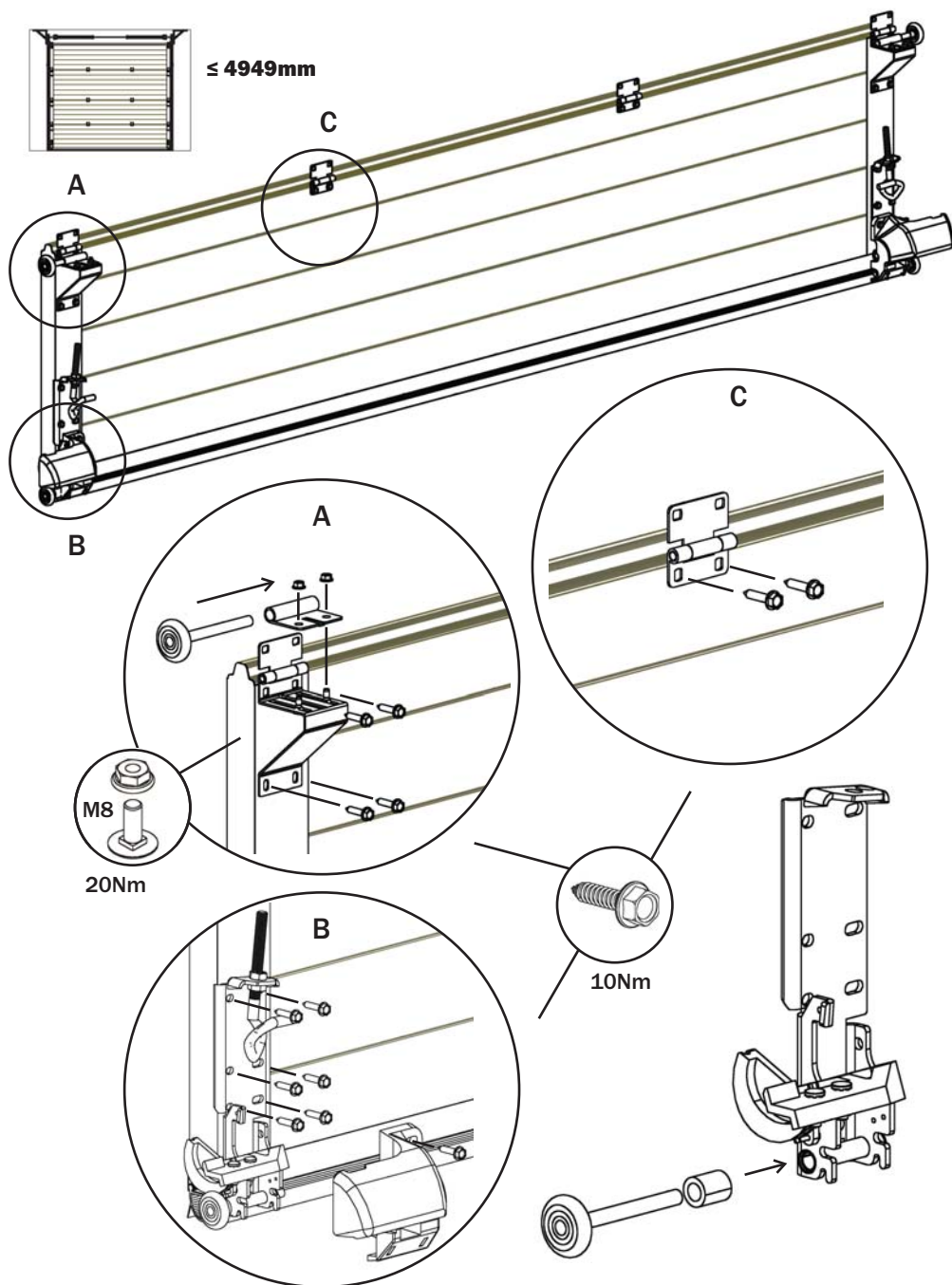

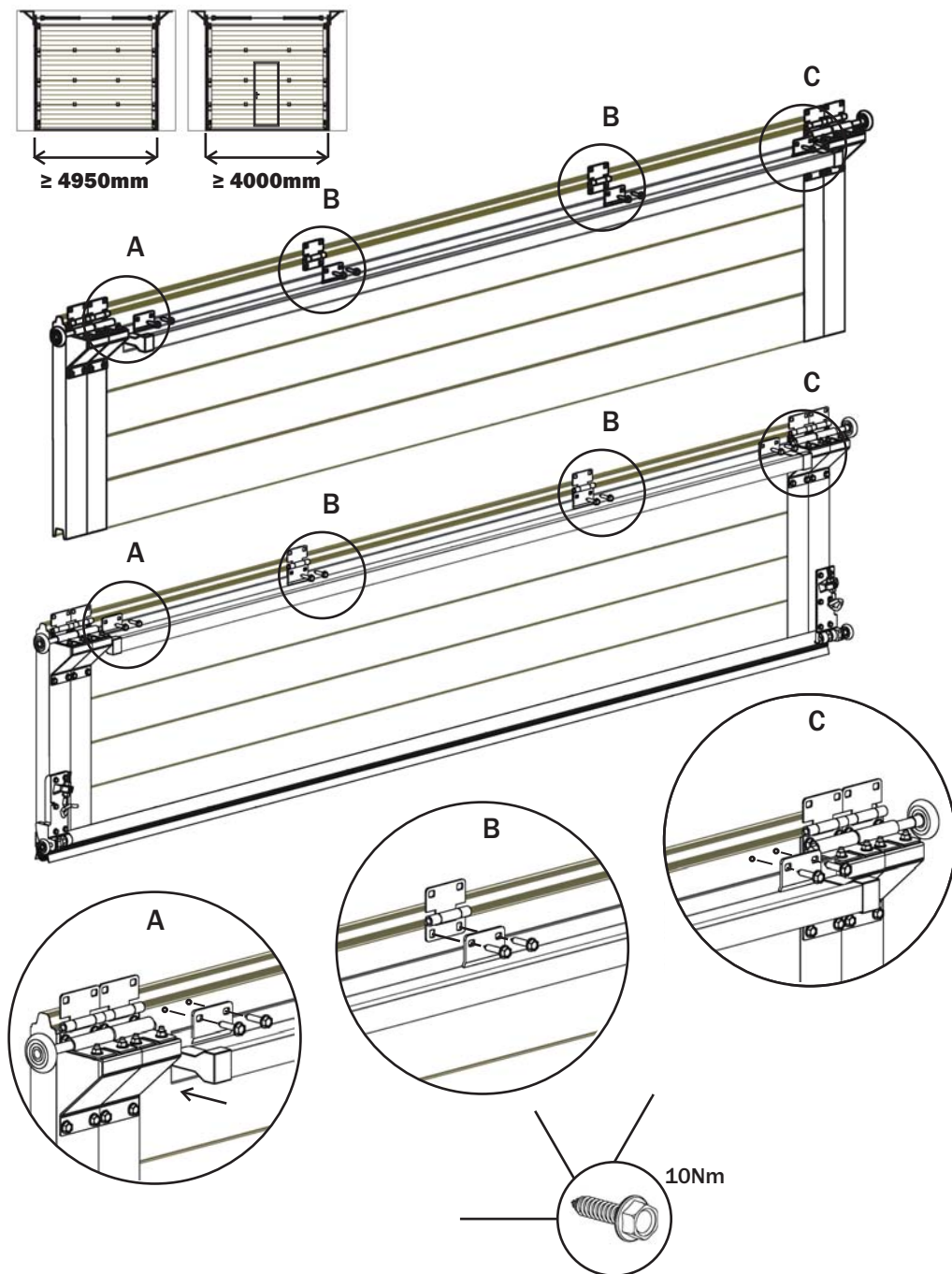

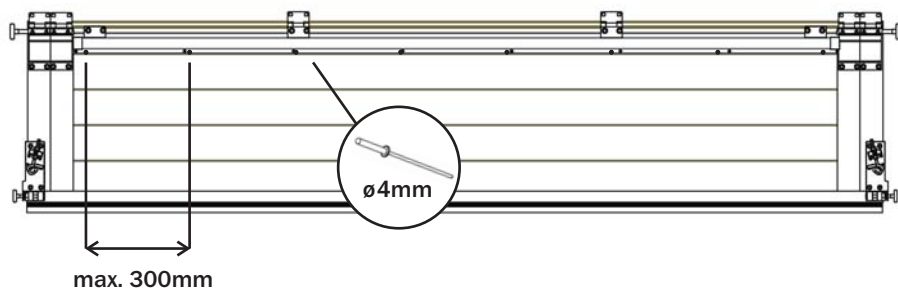
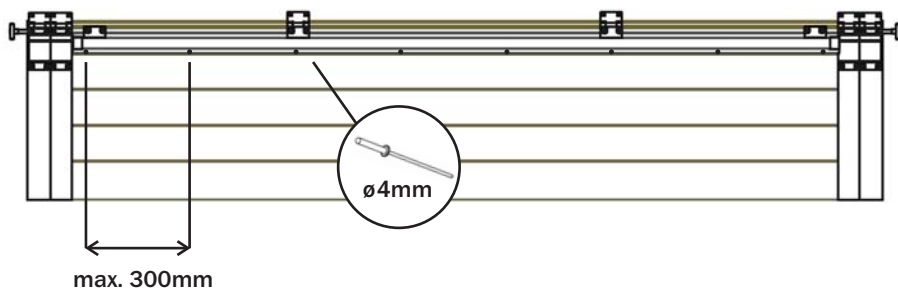
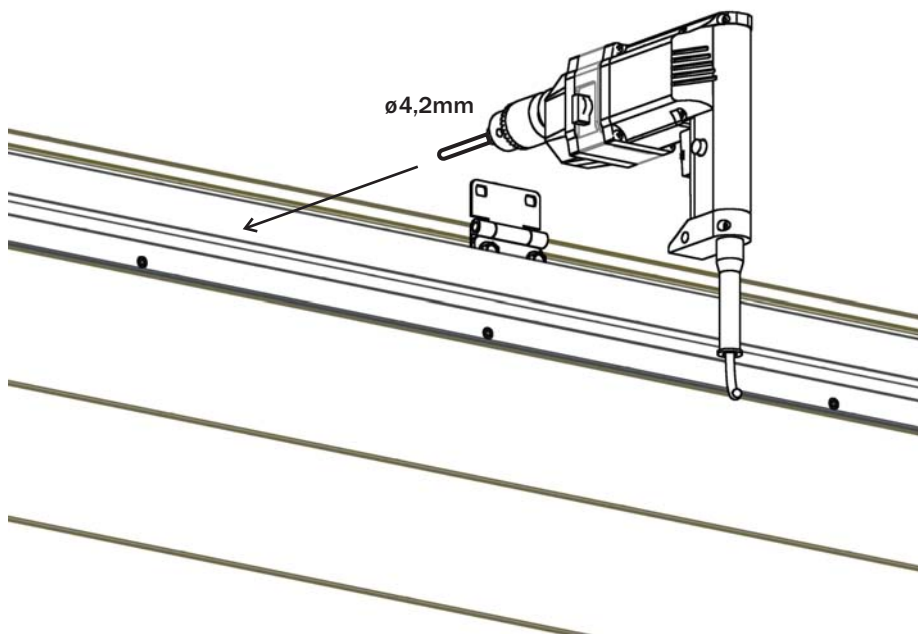

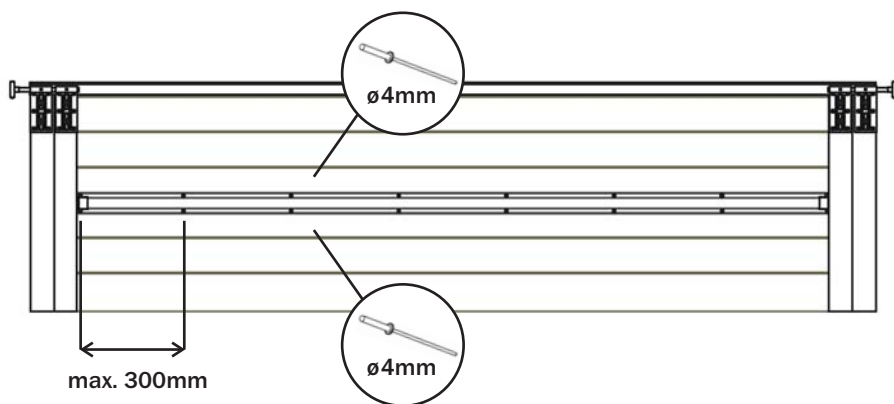
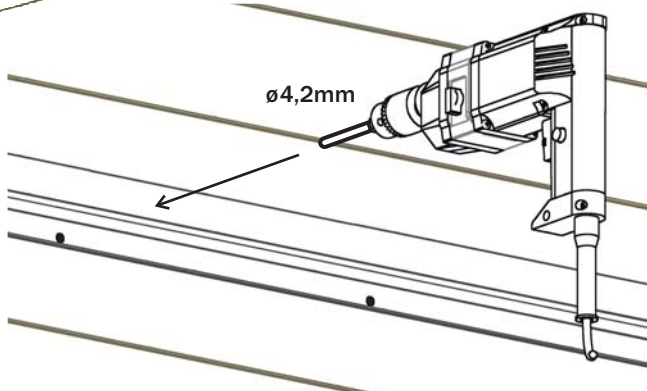
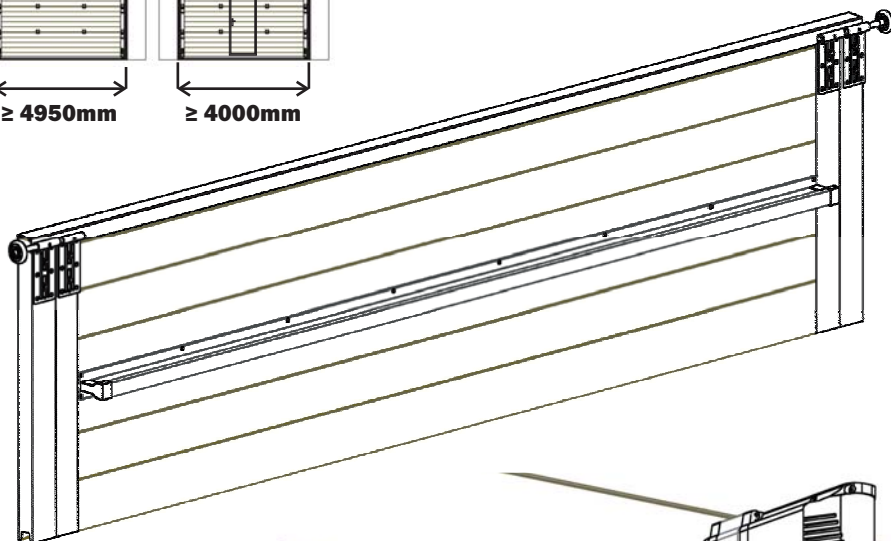
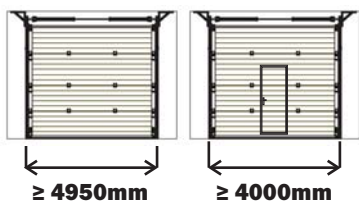

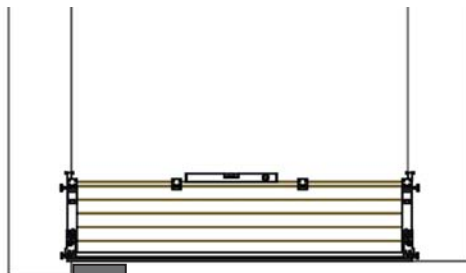
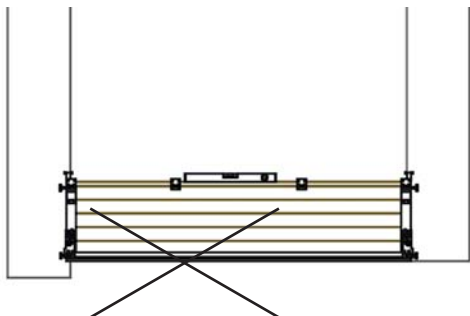
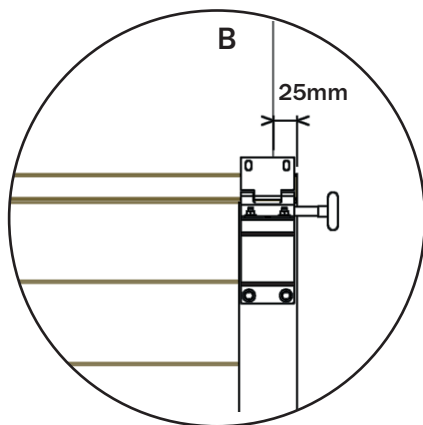
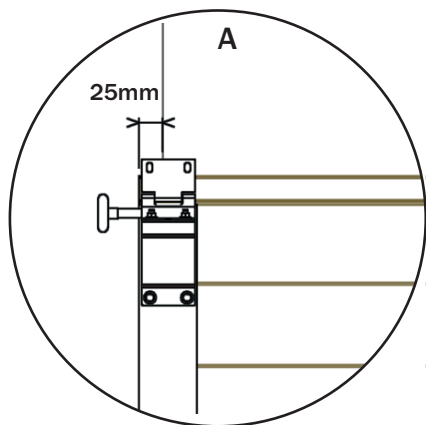
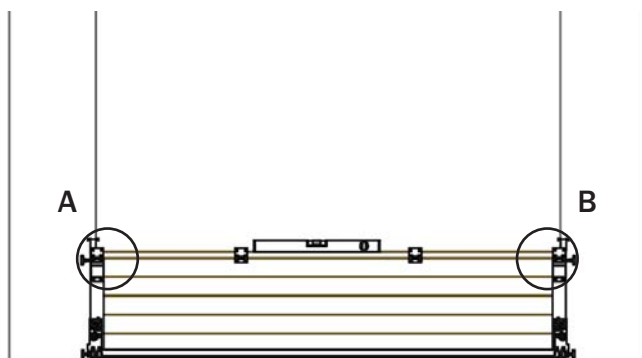

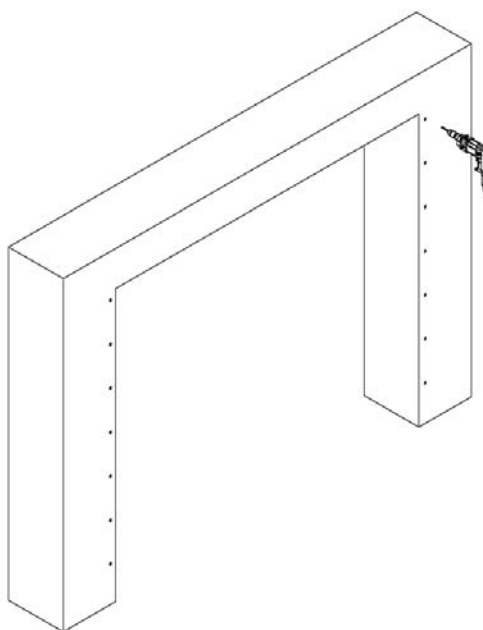
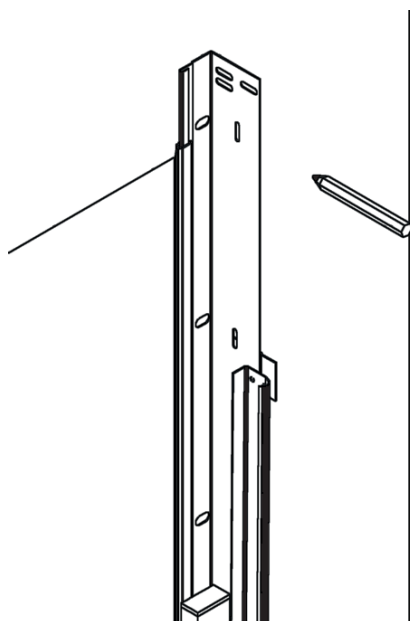
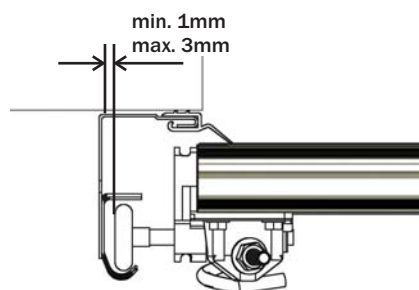
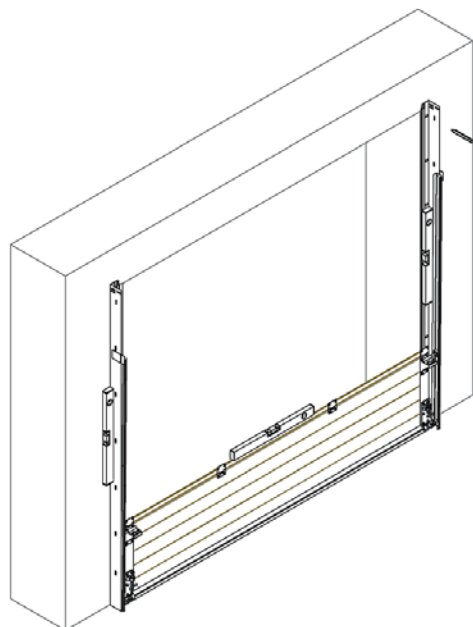

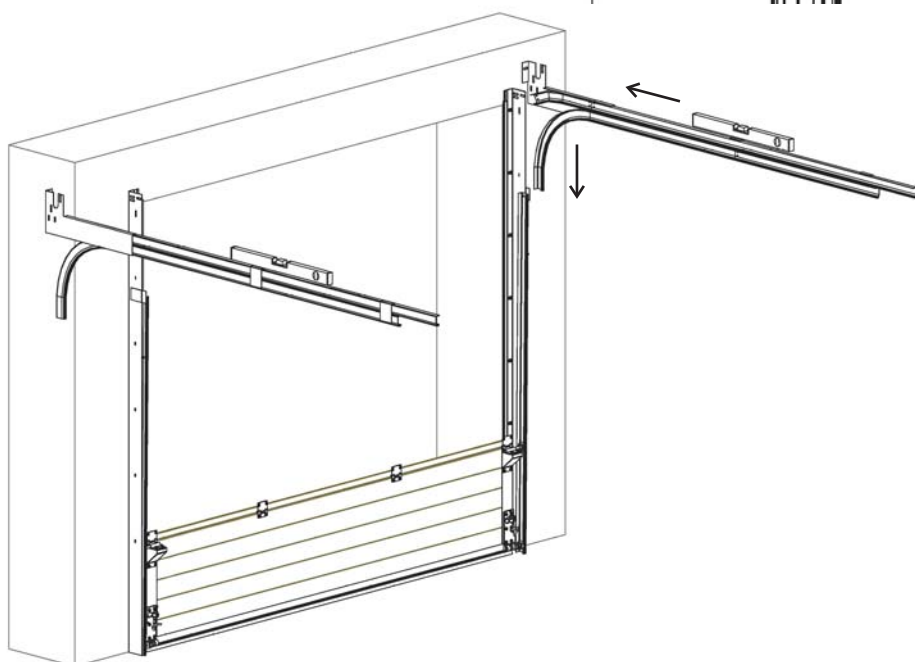
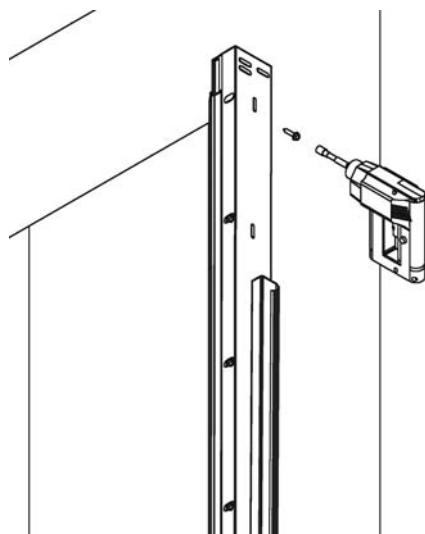
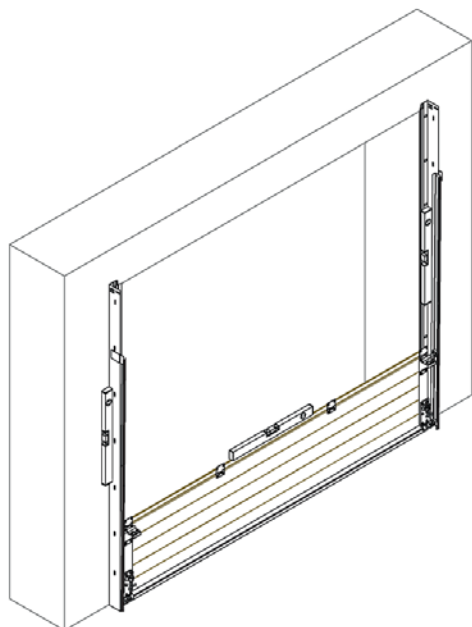

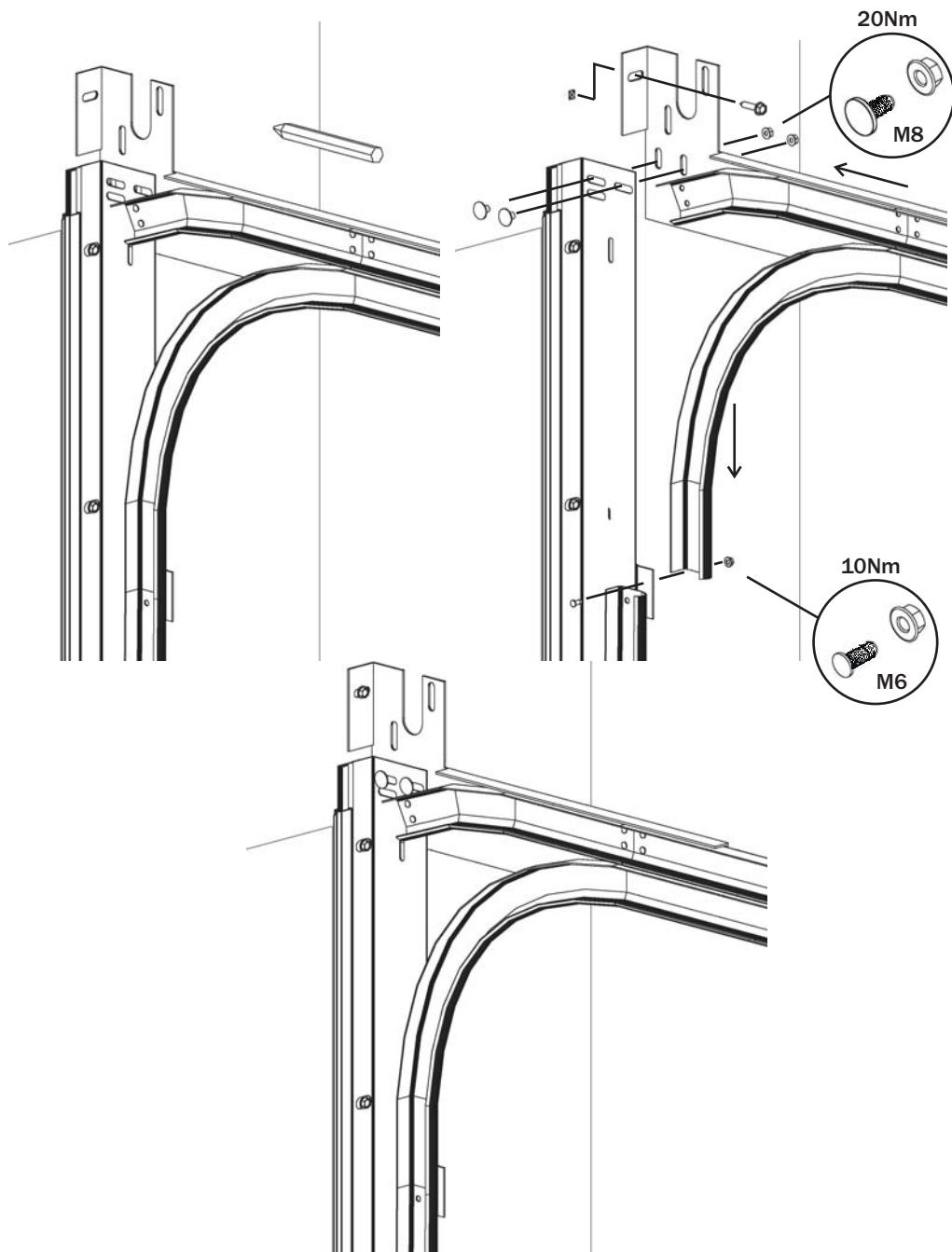

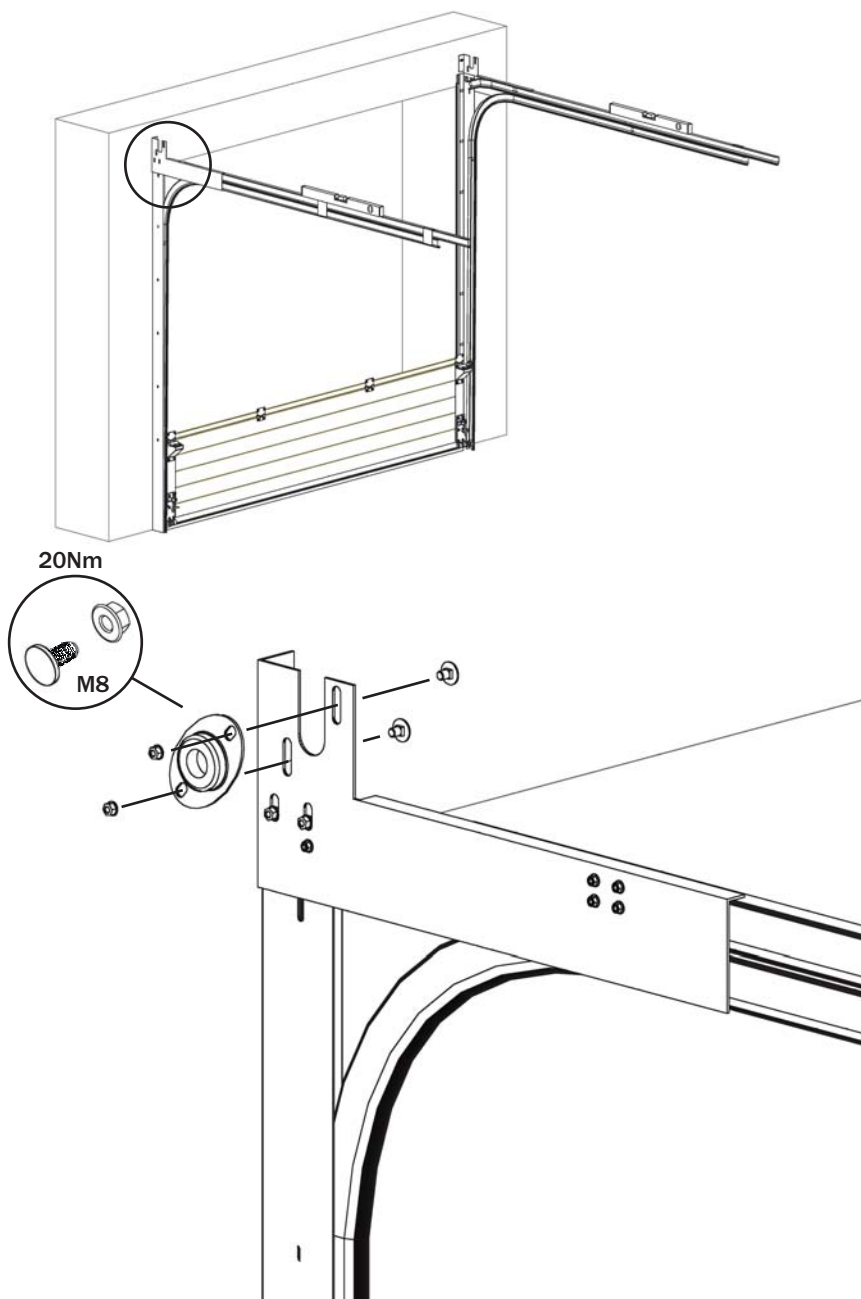

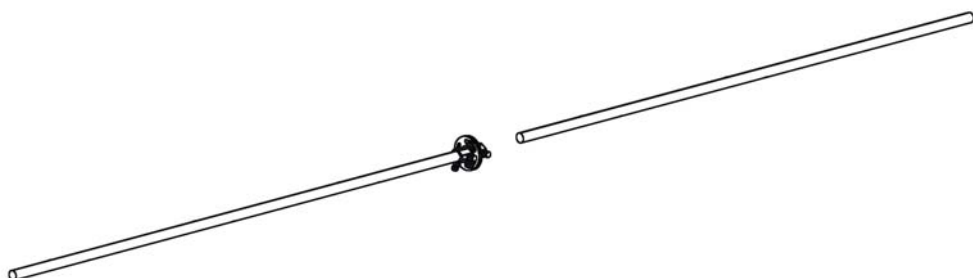
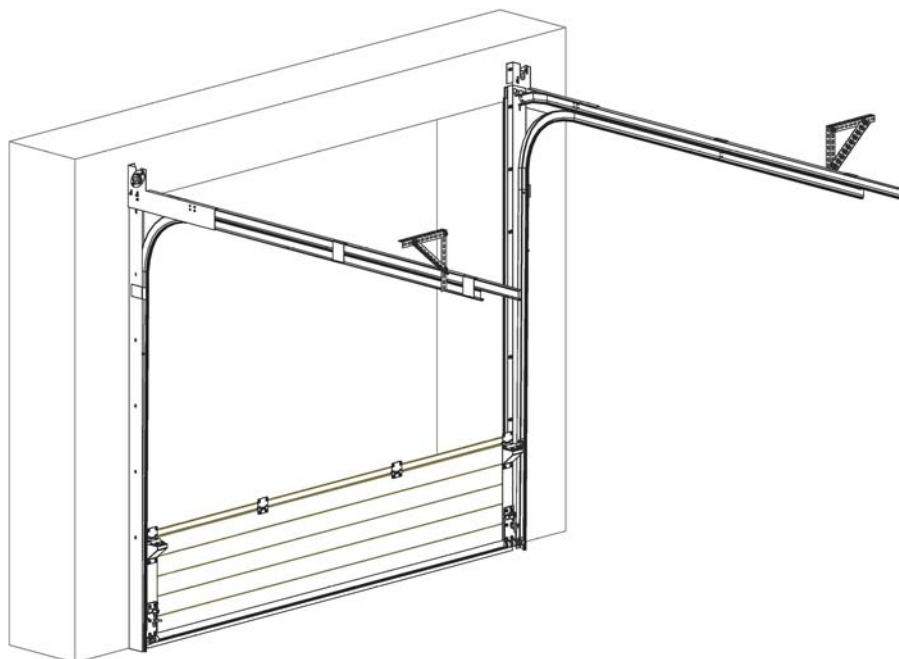

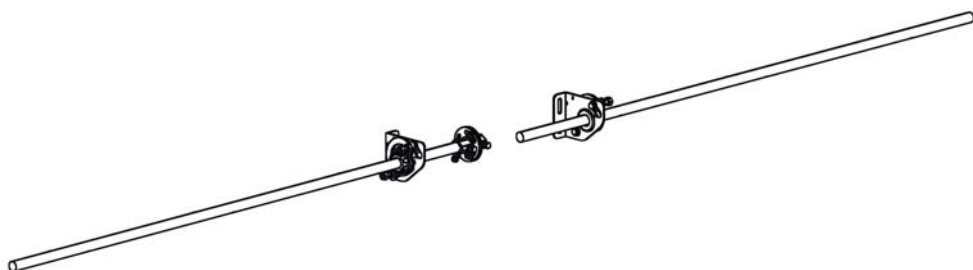
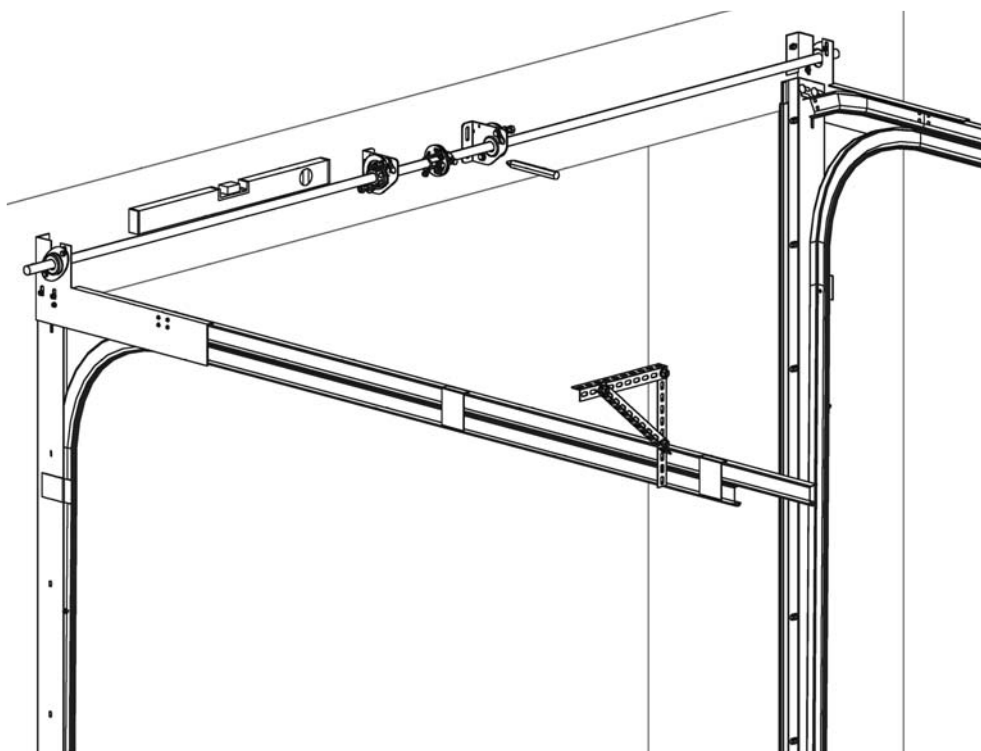

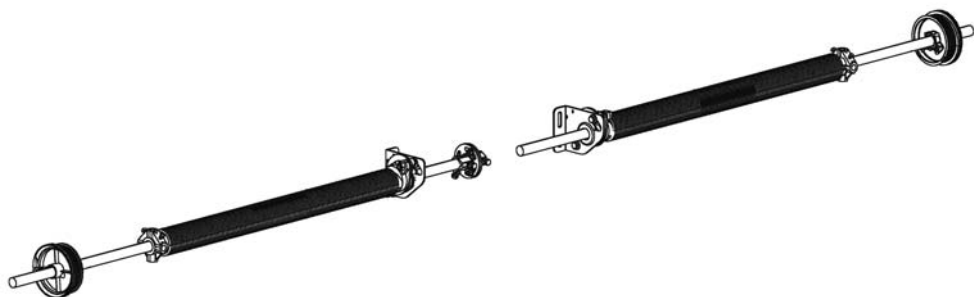
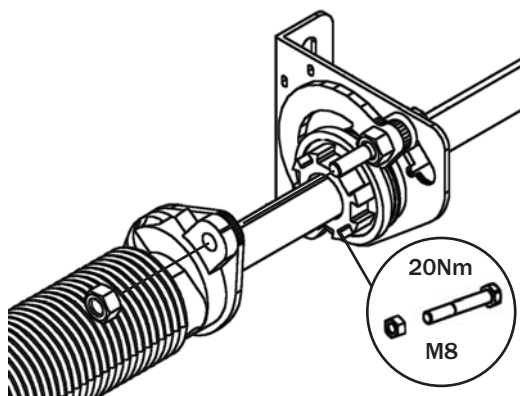
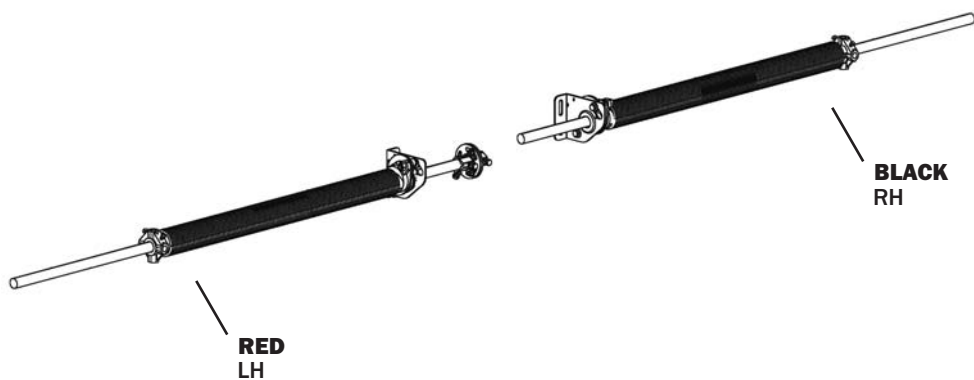

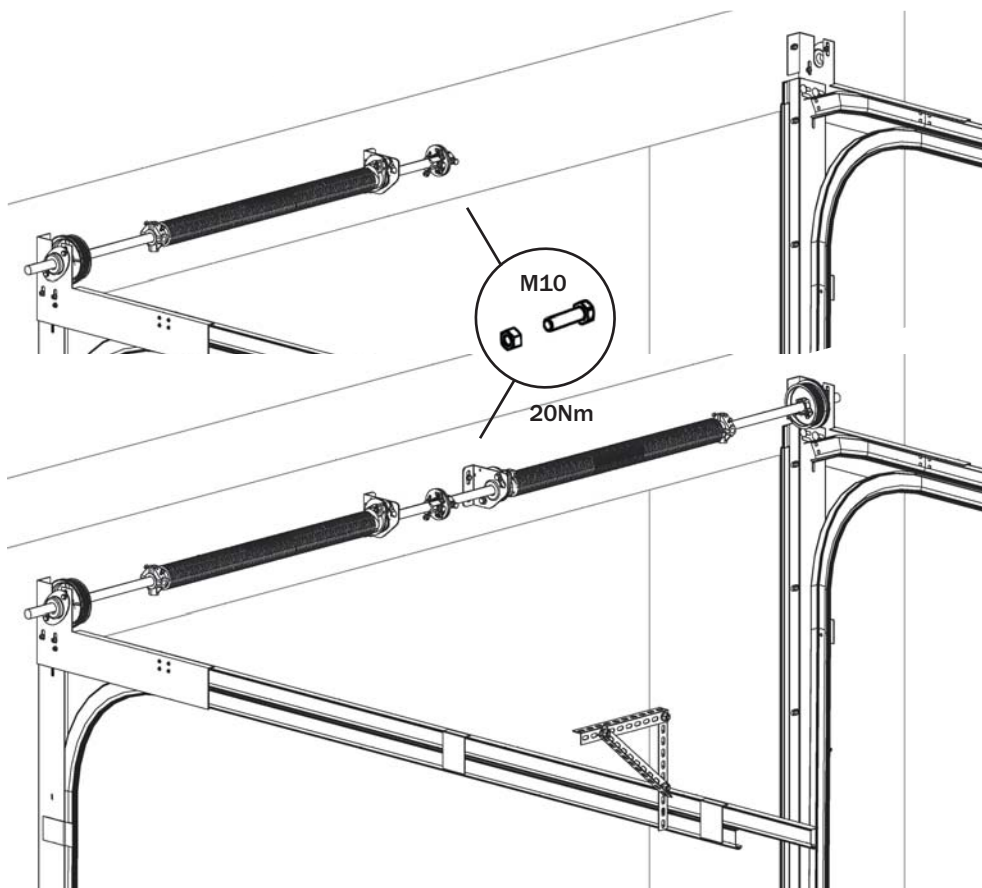

X = X

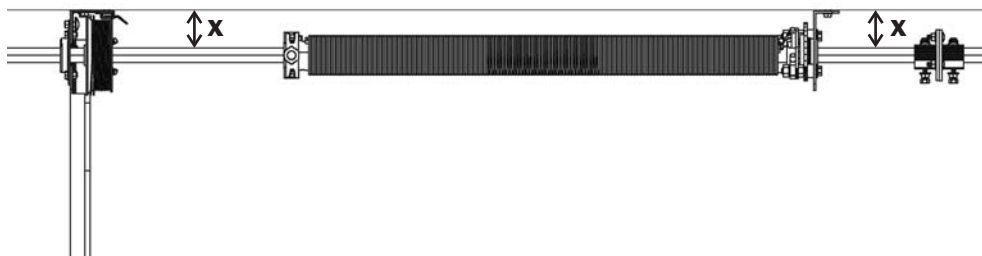

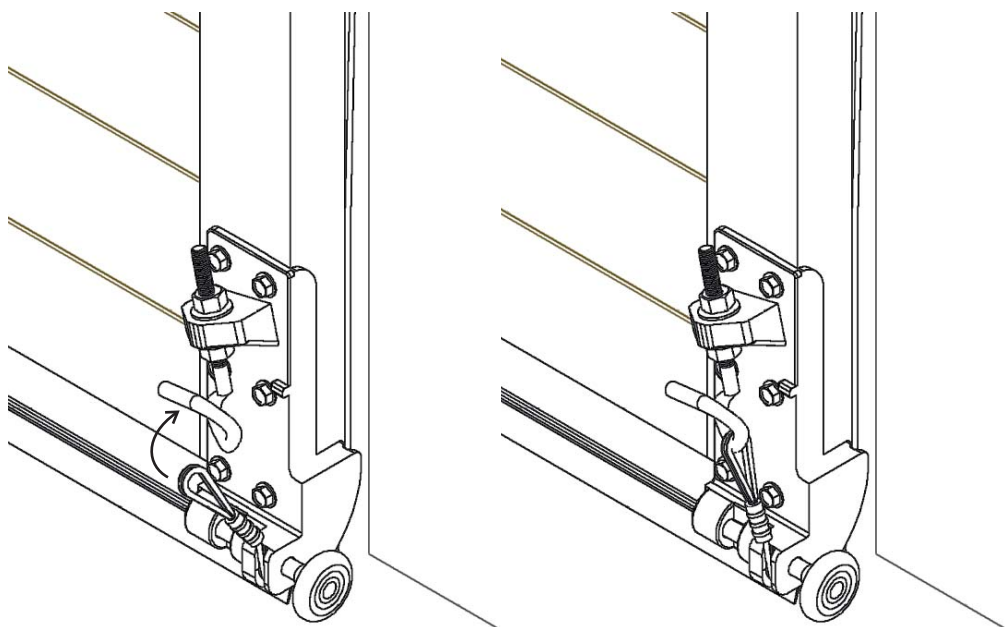
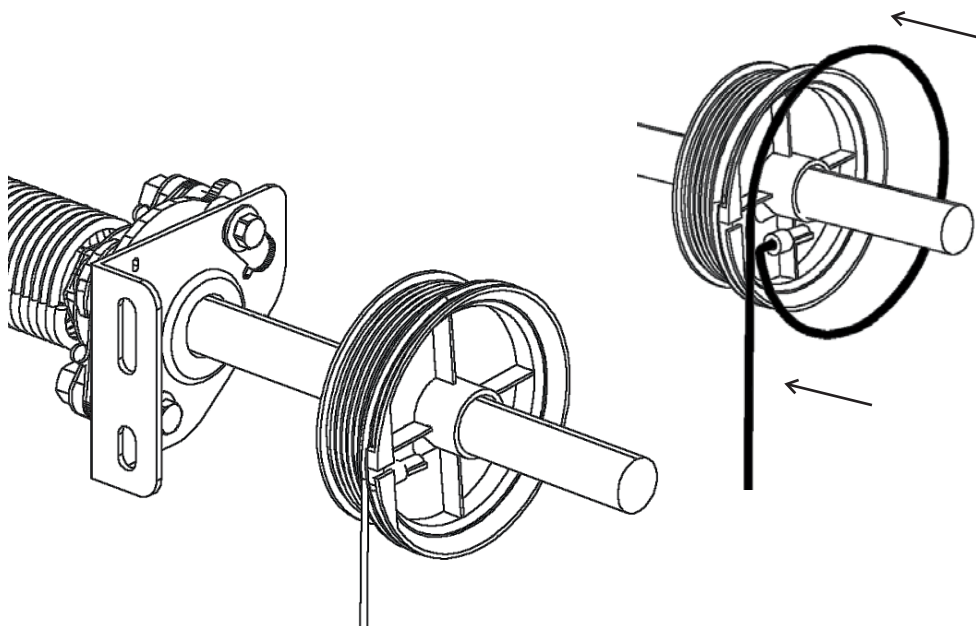

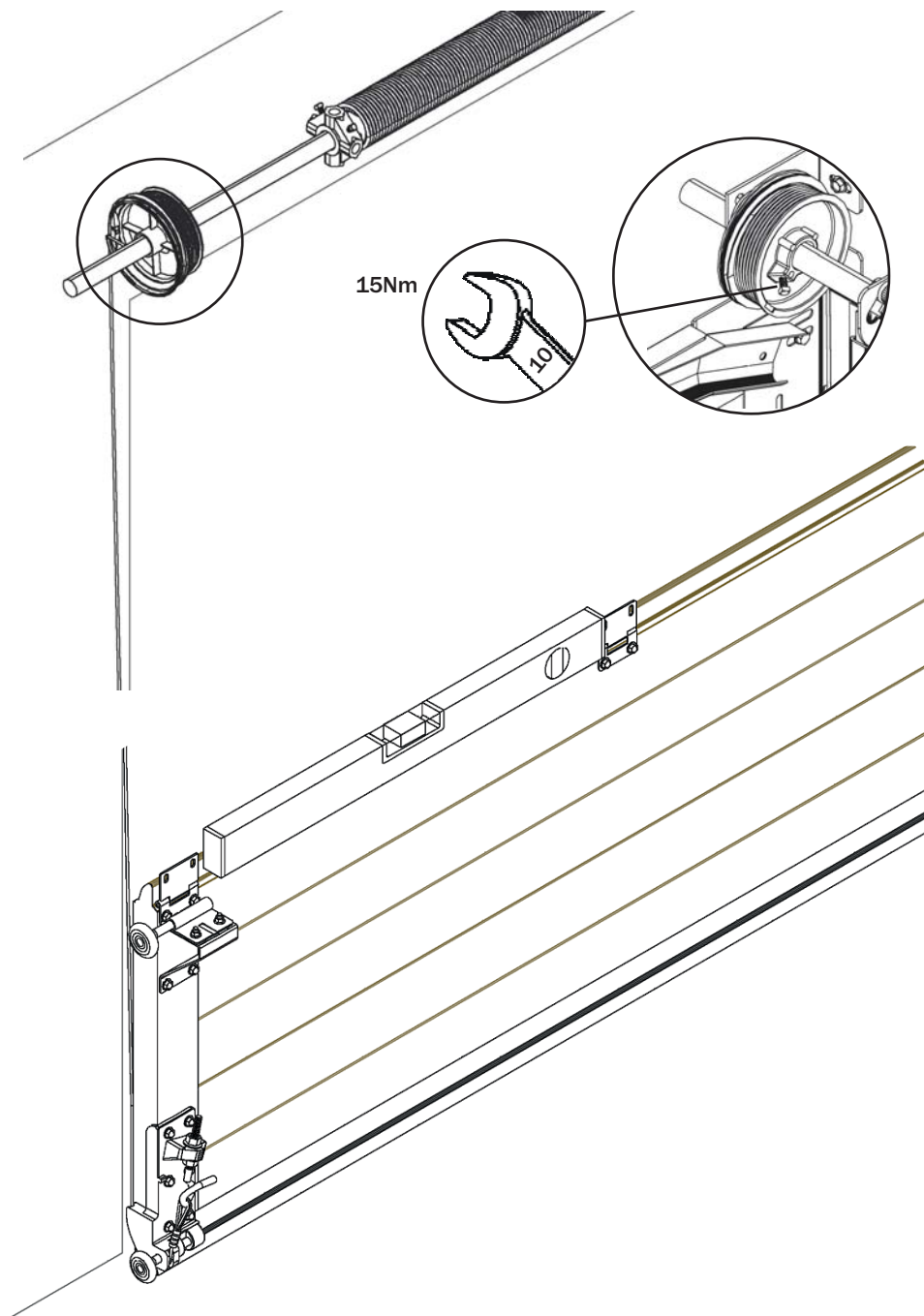

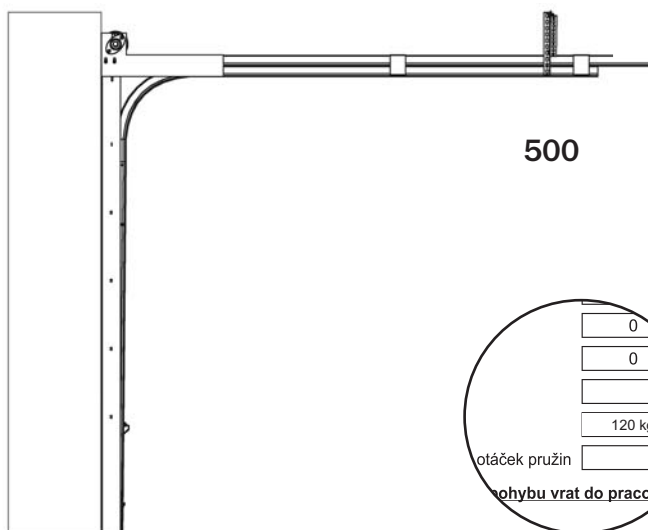
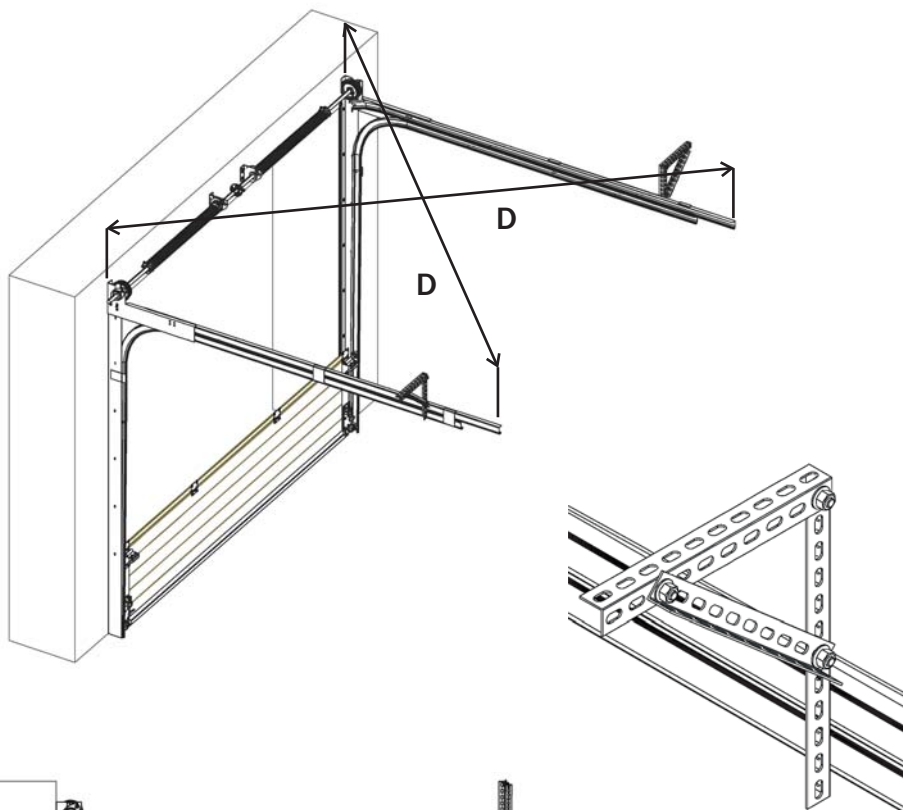

500



otáček pružin

přesun vrat do provozu

Výrobce Kružík s.r.o. Velislavova 2357 767 01 Kroměříž		 CE
EN 12543-1 (Směrnice)		
SEKČNÍ VRATA		
výrobní číslo:	<input checked="" type="checkbox"/> X	
odolnost proti zatížení větrem:	<input checked="" type="checkbox"/> X	
součinitel prostupu tepla:	<input checked="" type="checkbox"/> X	
průvzdušnost:	<input checked="" type="checkbox"/> X	
vodotěsnost:	<input checked="" type="checkbox"/> X	
rok výroby:	<input checked="" type="checkbox"/> X	
váha vrat:	<input checked="" type="checkbox"/> X	
orientační počet otáček pružin	<input checked="" type="checkbox"/> X	
Zákaz vstupuje při pohybu vrat do pracovního prostoru vrat!		
UPOZORNĚNÍ		
Každých 6 měsíců kontrolovat: Navíjecí lanku, navíjecí bubny, šroubové spoje, pružiny. Vyčistěte a promazání všech kluzných ploch i ložisek (torzních pružin, parů, koleček). Vyčištění vodících kolejků.		
Při větším rozsahu opravy kontaktujte montážní firmu.		

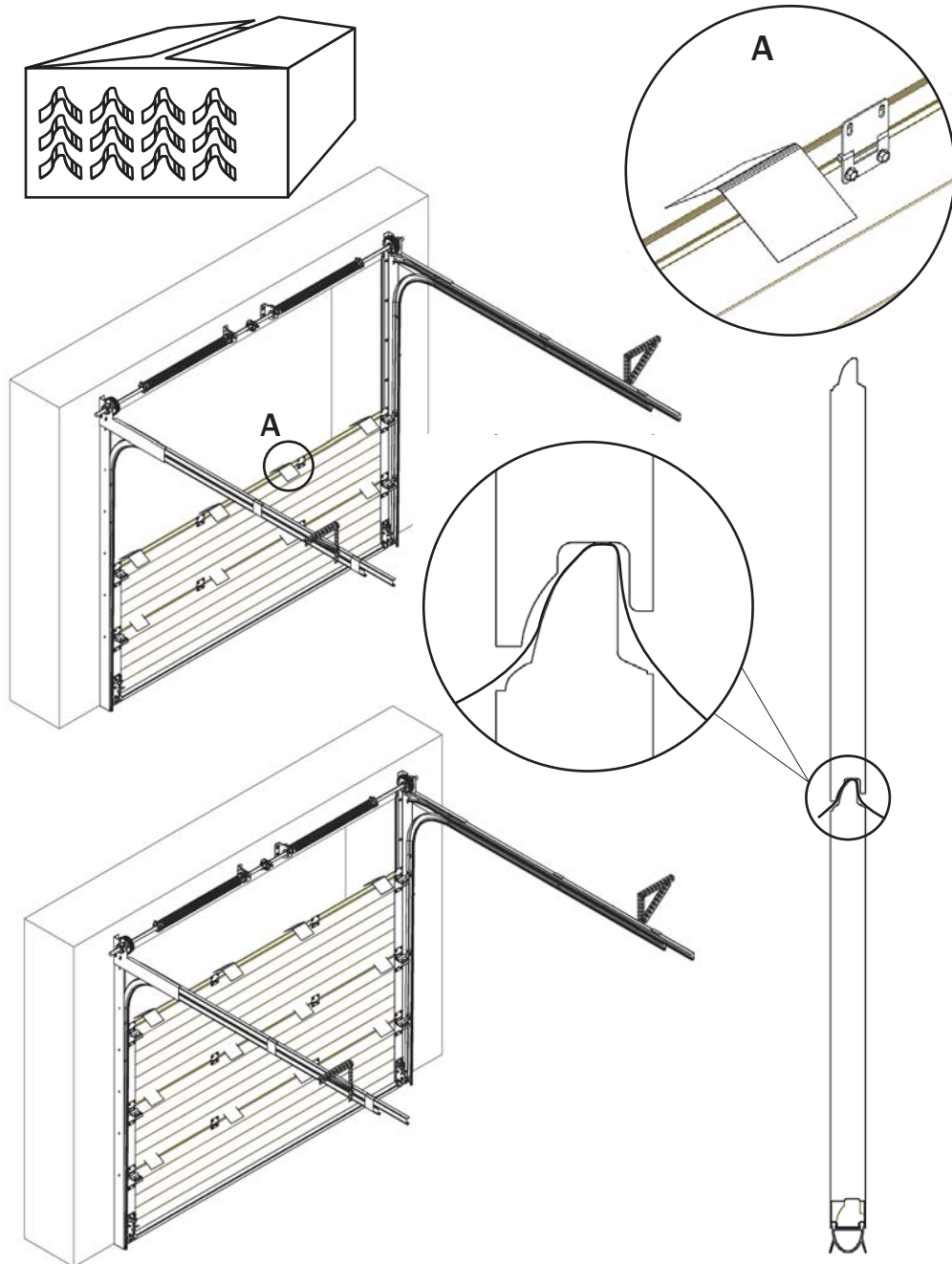

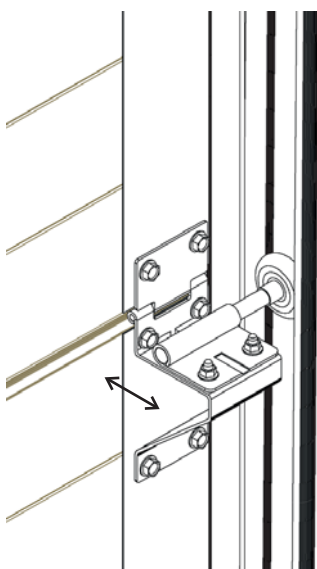
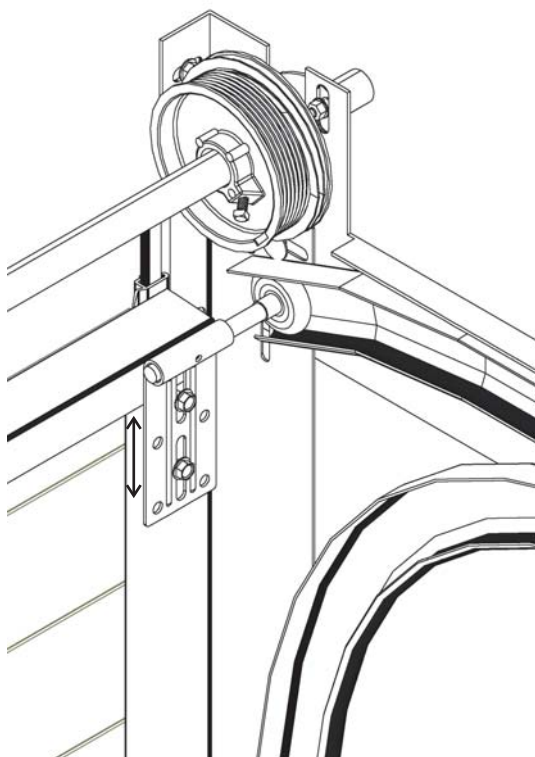

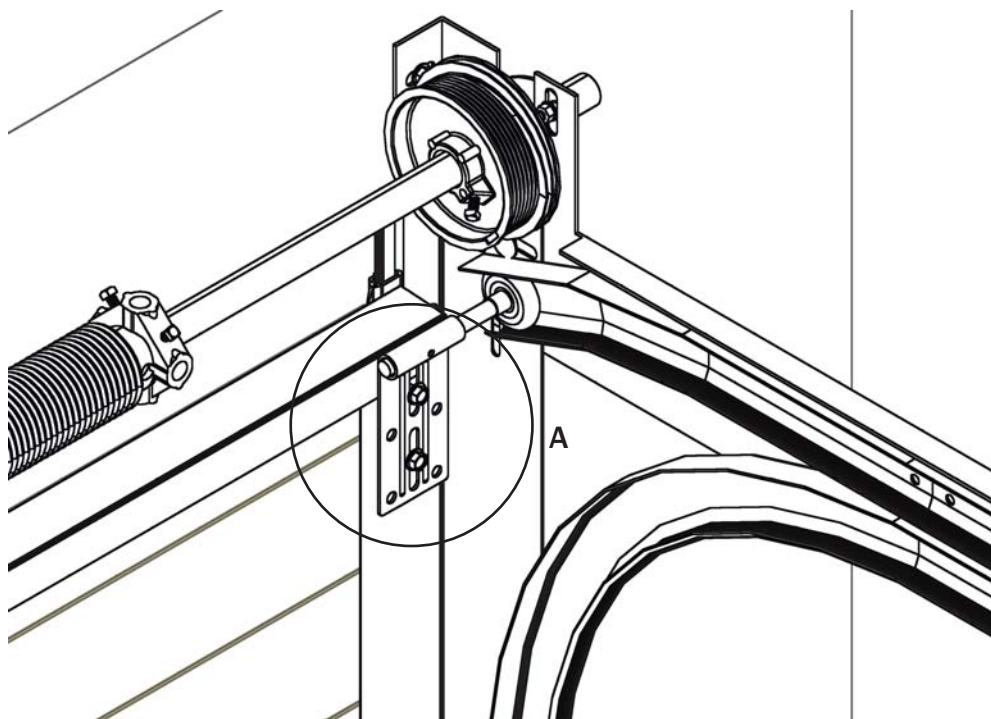

10Nm

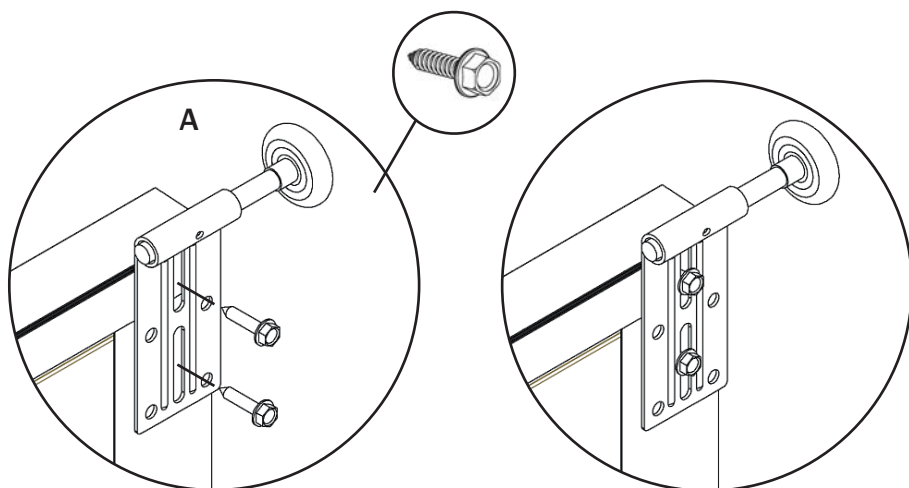

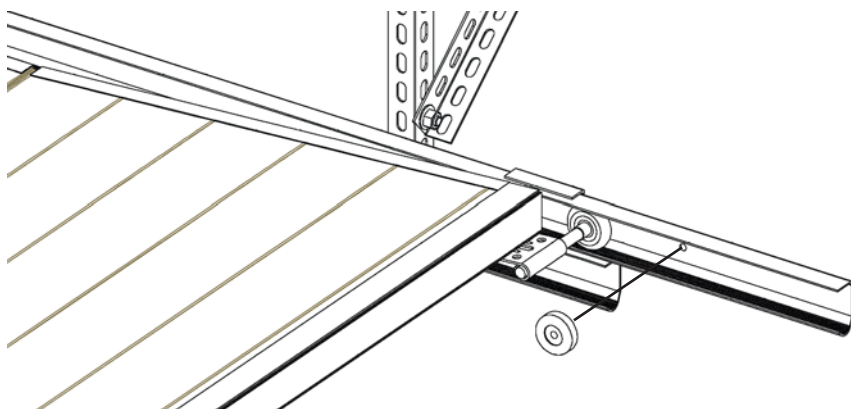
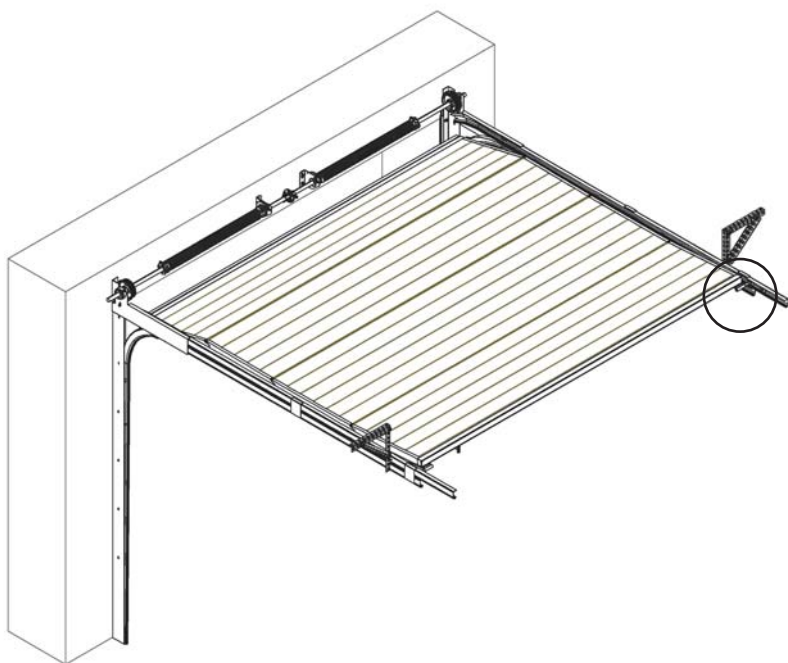

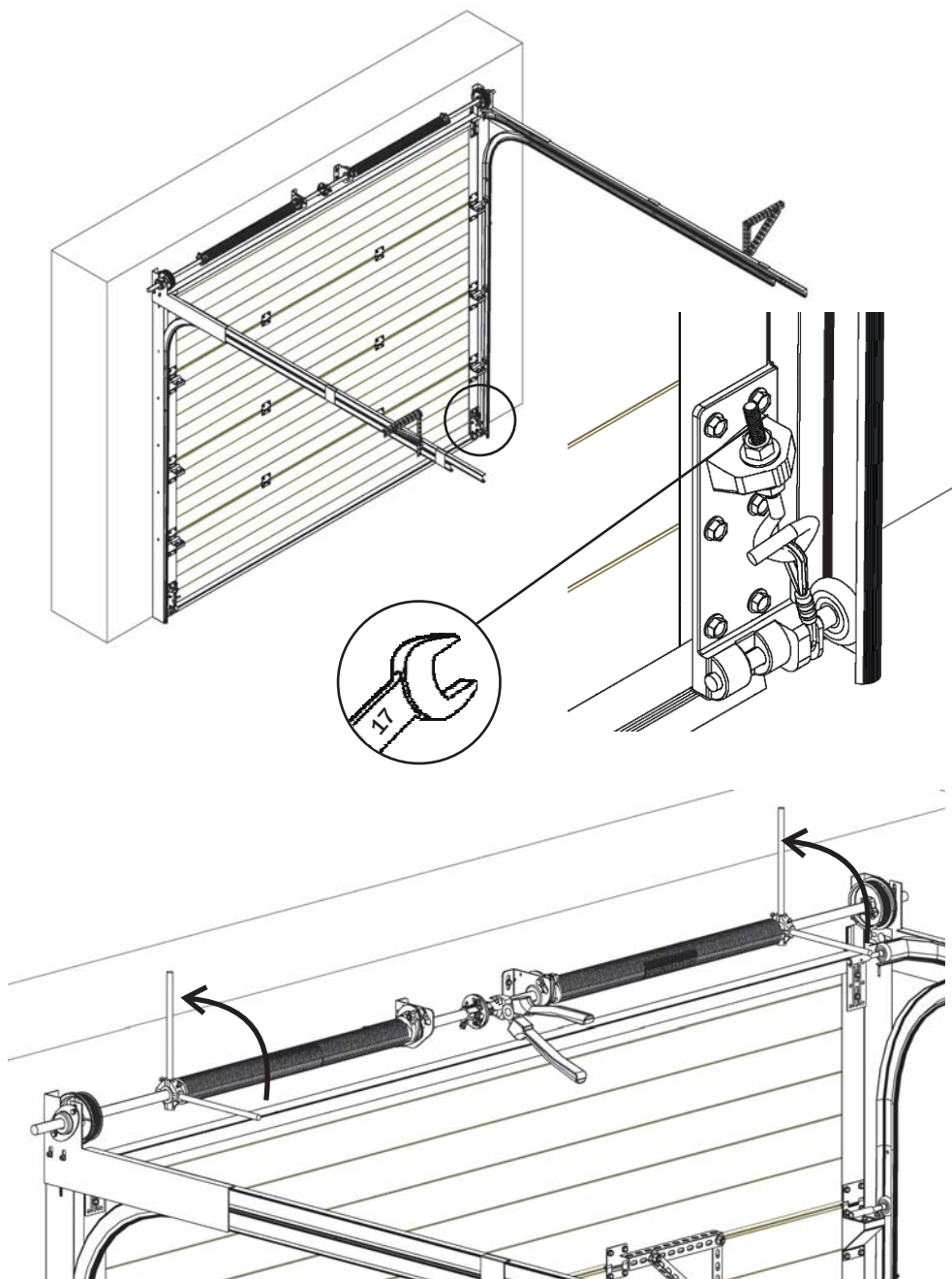

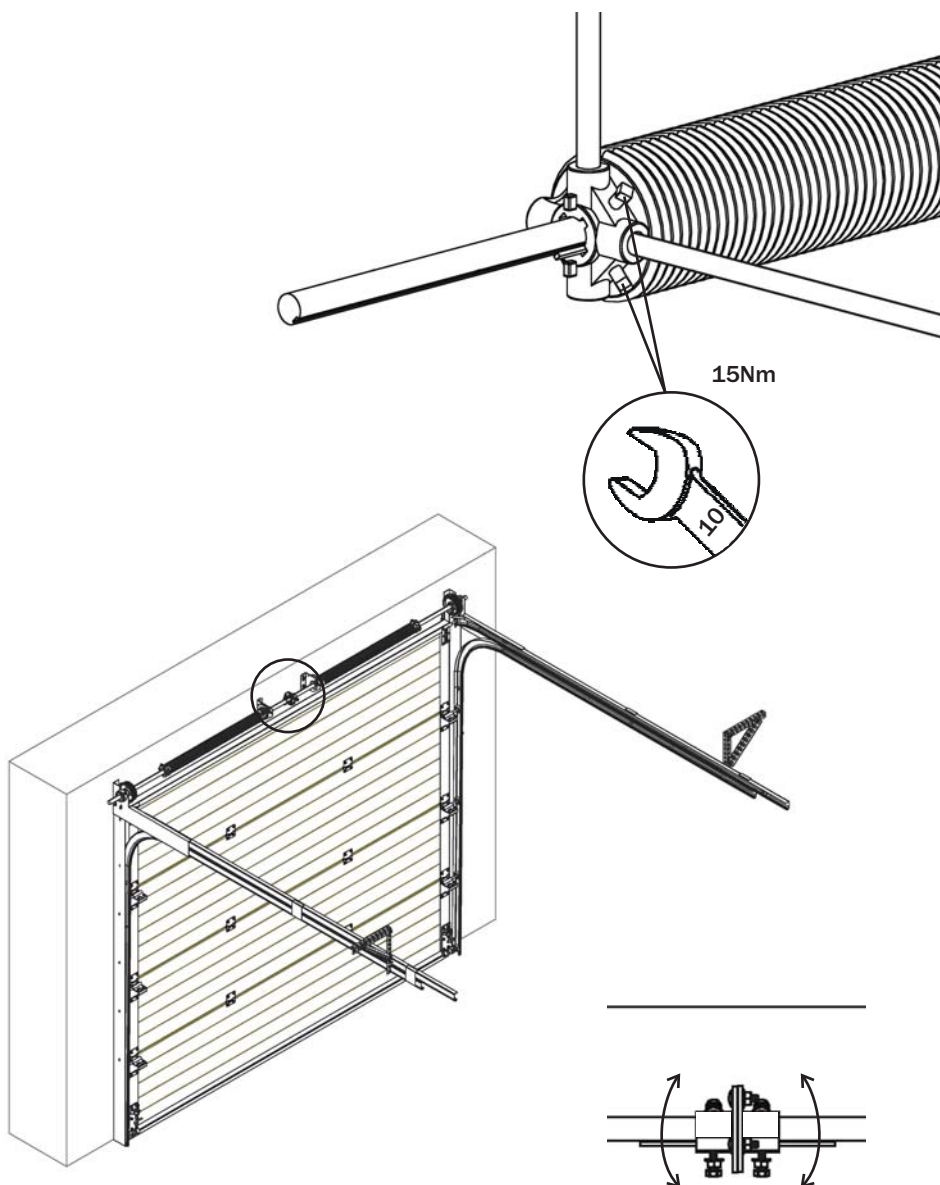



≤ 300kg

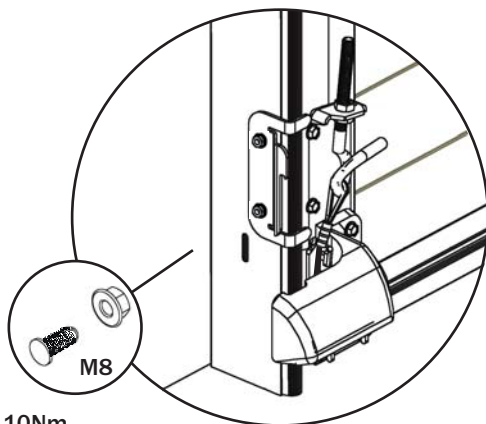
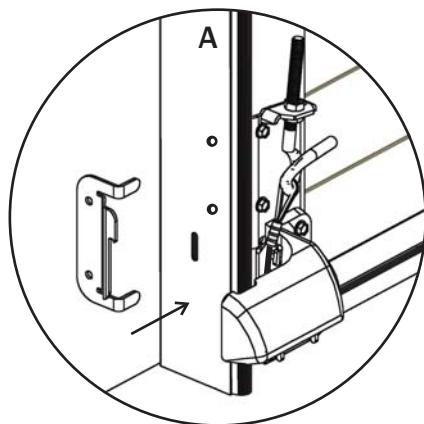
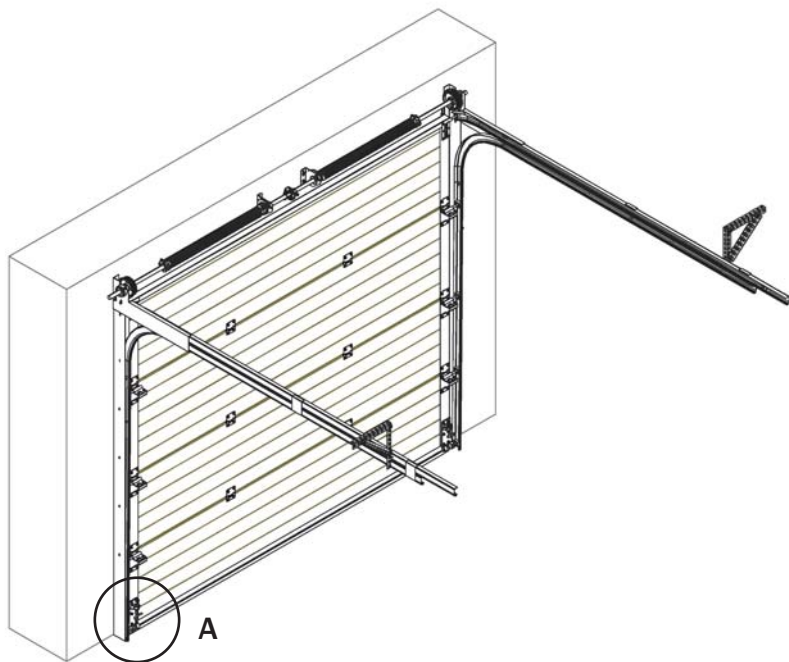

10Nm

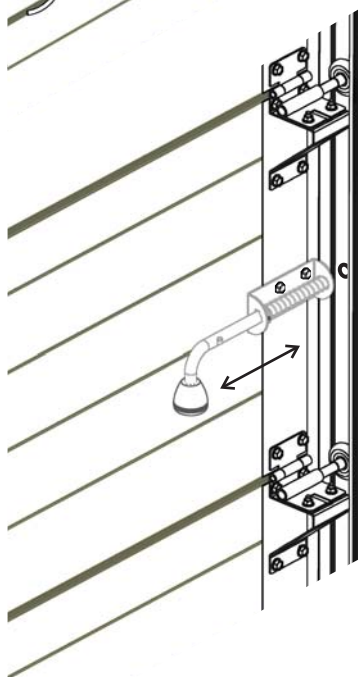
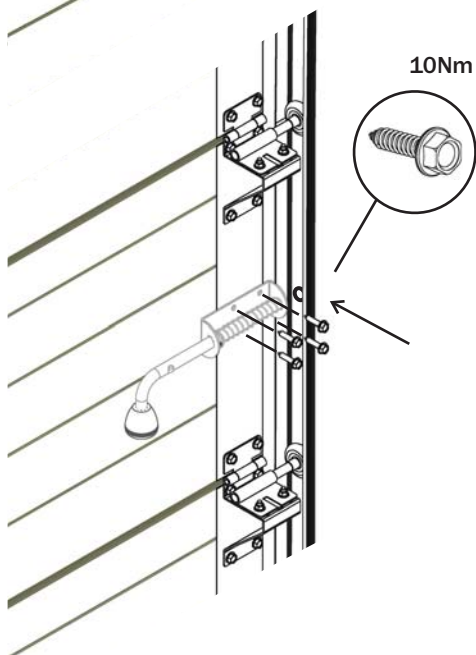
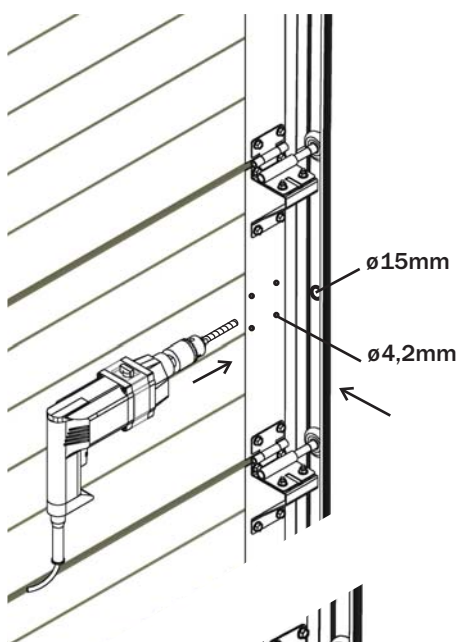
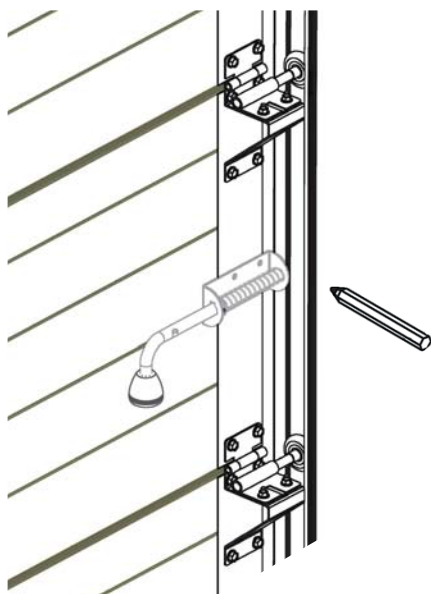

Instructions for demounting

The sectional door has to be closed before demounting!!!

Don't do demounting works until you don't cushion the torsion springs!!!

1) Torsion bars cushioning

First put the tension rod into the spring head and then disengage release the ensured screw on the torsion spring. Cushion the torsion spring and turn the spring head in its power wise until the spring power stops acting. For spring cushioning of garage doors we need two tension rods with a diameter 11,5mm and for industrial doors with a diameter 16mm.

2) Panel demounting

After the spring cushioning begin to demount the top, middle and side hinges. Begin to demount always from the top panel. After demounting the hinges on the panel remove it immediately. Repeat this procedure for all panels. Unscrew the winding wire by the lower panel hinge and also remove this section.

3) Demounting of torsion springs, drums and torsion bars

Disengage the ensured screws on the drums and the ratchet-wheel of spring break protection. Then unscrew the torsion springs from the spring break protections. In case of two shafts demount the coupler. When using an industrial door opener, it has to be demounted from the torsion shaft before removing the shaft. Move the shaft to one side to pull it out of the spring break device. Then take it down from the console.

4) Demounting the console and the spring break device

After demounting the torsion shaft demount the spring break devices and the consoles from the lintel.

5) Demounting the horizontal tracks

Unscrew the perforated mounting profiles from the ceiling and also the screws connecting the horizontal and the vertical tracks.

6) Demounting the vertical tracks

Unscrew the vertical tracks from the door opening.



KRUŽÍK® /

Kroměříž, Veleslavínova 2357, [tel.] 573 336 233, [fax.] 573 343 582
Praha 10 Hostivař, Herbenova 38, [tel.] 267 710 901, [fax.] 267 710 696
г. Мукачево 89622, 000, "Кружик Украина", с. Ивановцы, ул. Мира, 3, [тел] +38-050-523-59-69

18022017

www.kruzik.cz | www.kruzik.com | www.kruzik.com.ua | www.kruzik.eu